



# Photoetch Set



## INTRODUCTION

Thank you for purchasing ParaGrafix's photoetch set for the Fujimi Spinner kit. We have made every effort to make this set as easy to use as possible, but please note that there are portions that will require some cutting of the kit parts and other more advanced techniques.

### Callout Error - Original Release

If you are working with the original release of this photoetch set\*, please note that callout 14 on the fret incorrectly has an arrow pointing to the left. That is actually part 13 (as noted by the number at its bottom left-hand corner). Part 14 is actually the part to the right of callout 14. (Part 15 is the one located below callout 15.) \* The original release does not have a "REV #" noted on it.

### Materials

In addition to the photoetch, you will also need scissors or a knife\* to remove individual pieces from the main fret, a file to remove material left from cutting, and super glue (aka CA or cyanoacrylate). Additionally, to fold some pieces, you may need a pair of razor blades\*\* or a specialty tool such as an Etchmate 3C from Mission Models.

\* We prefer a #17 Xacto chisel blade.

\*\* Extreme care must be taken when using razor blades. Risk of serious injury.

### Raised Detail

Each part of these instructions notes an area where the raised kit detail must be removed. This may be done in whatever way you are most comfortable: sanding, filing, chiseling. Note that in most cases the surface does not need to be perfectly smooth as the photoetched part will replace the "lost" kit detail.

### Lighting Options

Unless otherwise noted, you can prep areas for lighting by removing plastic from areas where there are through holes in the photoetch. You can then backlight the photoetch. For best results, we suggest using Micro Kristal Klear from Microscale Industries ([www.microscale.com](http://www.microscale.com)) to fill the through holes. MKK can be tinted for different colored lights. We suggest using MKK as the adhesive for the backlight films.

### Installation Order

Although we reference the kit's installation steps, when you modify the kit parts and install the photoetch parts is up to you.

Key	
Kit part (plastic):	1
Photoetch part:	1
Backlight Film:	A

## Side Vents

### Kit assembly step 2

Open up the vents on kit parts B8, B9 and A1. Attach photoetch parts 17 and 18 as shown on both sides. Note that these vents were sometimes lit on the filming miniatures.

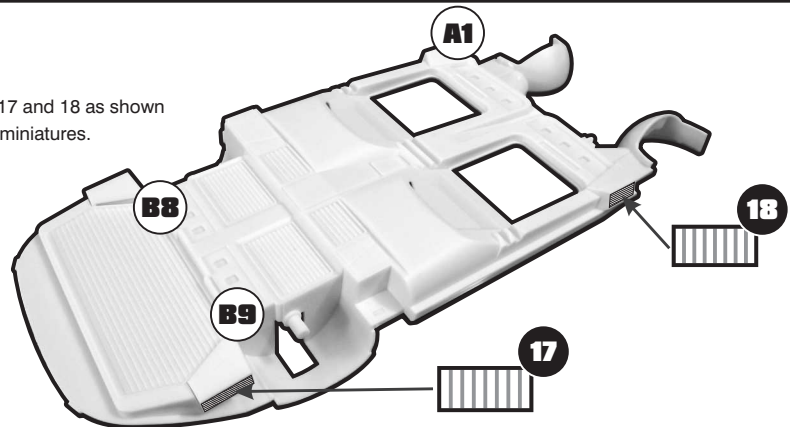

## Seats

### Kit assembly step 4

Trim the mounting points on seats D1 so that they are roughly even with the bottom of the seats. (You will trim the studs on the body later.) Attach seat "wings" (20 & 21) and head rests (11) as shown. Note that the sides of the head rests can be bent slightly forward.

 For added detailing, you can add some thin (1/16", 1.5mm) plastic sheet to the back of the head rests.

 The ribbed areas of parts 20 and 21 may be improved with some thin guitar string or other corrugated material.

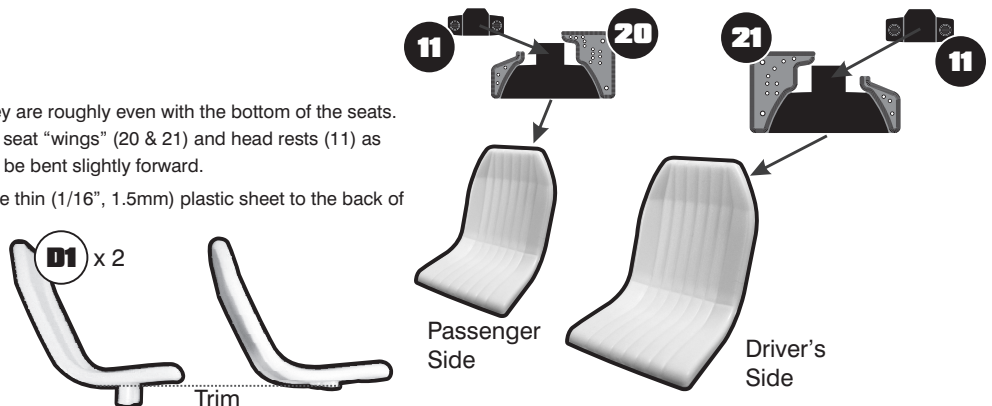

## Foot Wells

### Kit assembly step 3

Fold etch parts 2 and 4 and set aside.

Position the vinyl masks as shown, then fold the tabs down. Trace around the outline of the masks and then remove the masks. Cut out the areas that were covered by the masks.

**NOTE:** The photoetch parts have to fit against the chassis (A1) of the Spinner. When cutting out the areas, test fit the body and chassis with the photoetch taped in place as you get closer and closer to the proper fit. Remove too much material and there will be unsightly gaps; remove too little and the body and chassis won't fit together.

Attach the two photoetch parts with the open areas facing down.

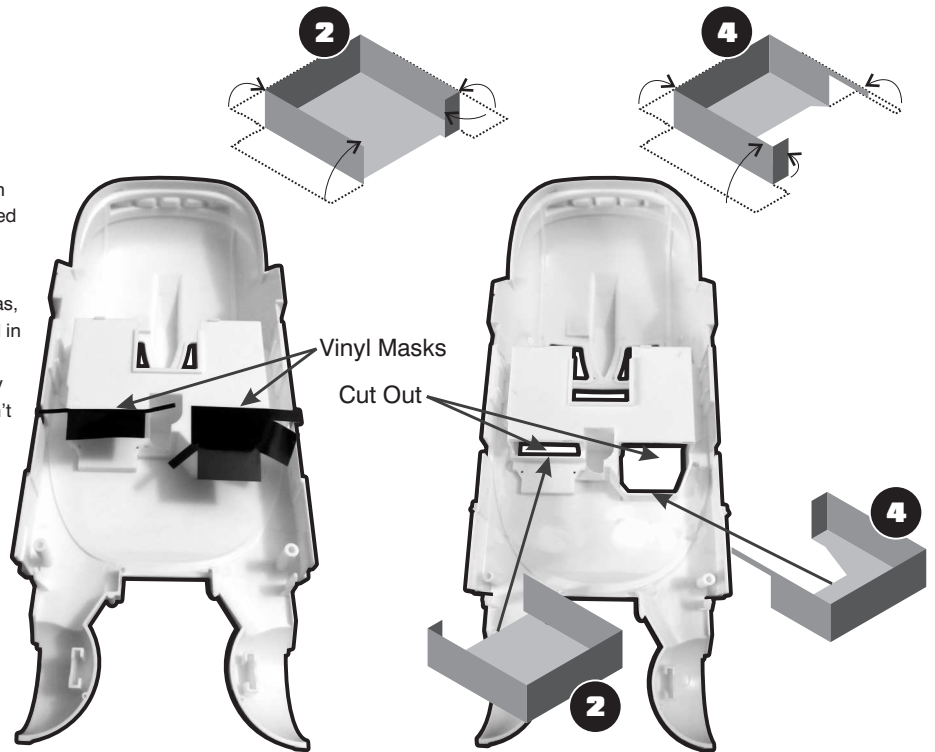

## Door Consoles

### Kit assembly step 3

Remove the raised panel details from the car's body. Notice that all of the control panel detail will be removed from the passenger (right) side, while only the "in between" areas are removed from the driver's (left) side. You may cut through holes in the plastic if backlighting these panels.

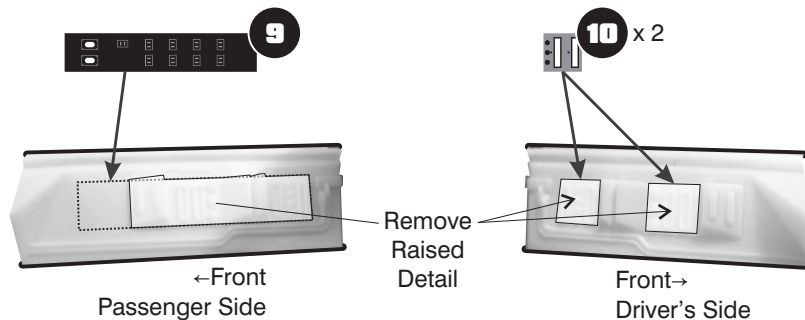

## Main Dashboard Console

### Kit assembly step 4

Cut the console (C10) off square to its top and remove any remaining material from the opening. Attach etch part 3 and your choice of backlight film B as shown. (Note that you will find it easier to paint the assembly before attaching the backlight film. Handles B2 and B3 may be installed normally.)



## Rear Wall, Center Console & Seats

### Kit assembly step 3

Fold etch parts 1 and 12 and attach to part 19.

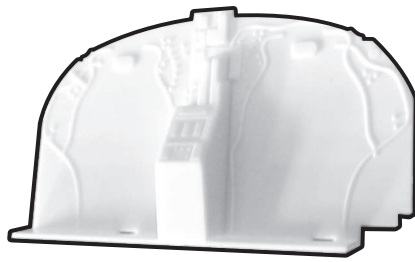

Before

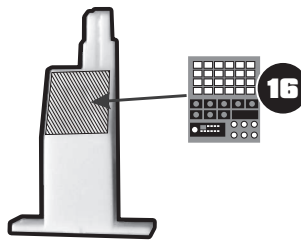

After

Remove the central column from the kit's rear wall. Sand the back portion until the kit wall is completely gone - this will allow it to fit flush to the new wall assembly. Leave a lip at the bottom to aid in assembly.

Remove the raised detail and cut a hole to allow light to pass through etch part 16.

Remove the raised detail from the kit's center console (C5) and cut holes to allow light to pass through etch parts 13 and 14. (Remember that etch part 14 is incorrectly labeled on the original release of this photoetch set.)

Install the remainder of the rear wall and the center console normally along with the rear wall. Note that the rear wall maintains the original part's angle of about 15 degrees as set by the rear center console.

This would also be a good time to install the seats. Trim the seat mounting studs down to about 1/8" (about 3mm) to accommodate the shortened mounting points on the seats.

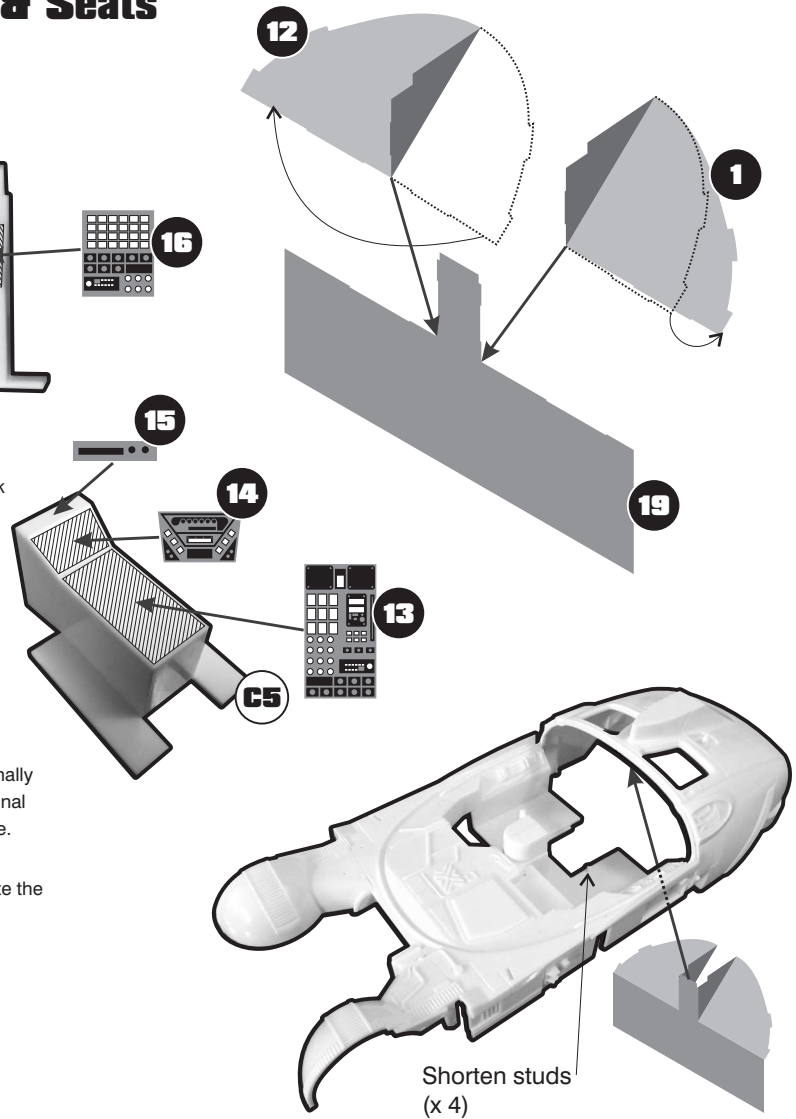

## Front Consoles

### Kit assembly step 4

Mount the dashboard (C10 as modified on the previous page) per the kit instructions. Note that for extra accuracy, you can tilt it upwards by about 15°.

Open up a hole for the VDT as shown and mount etch part 7 and your choice of backlight film A.

**TIP:** You can make the walkie-talkie (5) thicker and more accurate by adding a bit of sheet plastic to it.

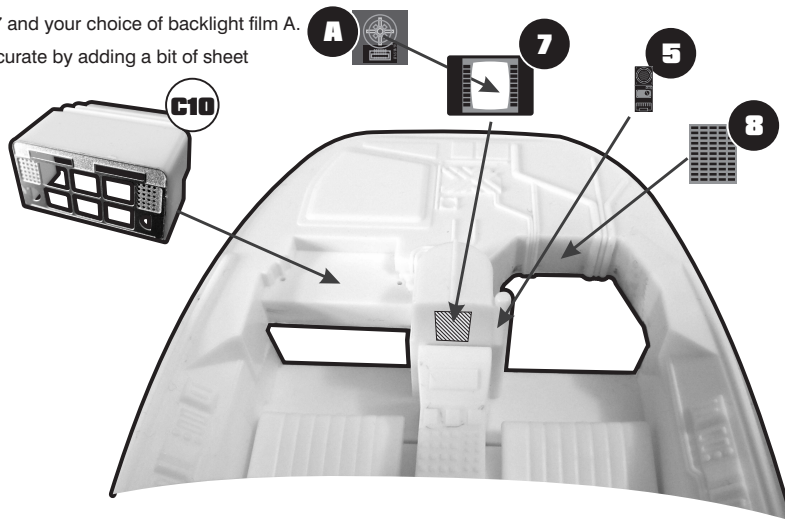

## “Visor” Console

### Kit assembly step 4

Fold the visor console (24) slightly inward to create a shallow arc. Fold back the two mounting tabs so that they are square to the main assembly. Attach the visor to the arm (6) and then attach the assembly to the rear console as shown. The visor can be rotated to any desired angle before gluing in place, and the arm direction can be adjusted at the fold line near its rear end.

**NOTE:** You will want to test fit the angle at which you mount the arm and console before attaching the windshield in kit assembly step 6.

**TIP:** You can make the walkie-talkie (5) thicker and more accurate by adding a bit of sheet plastic to it.

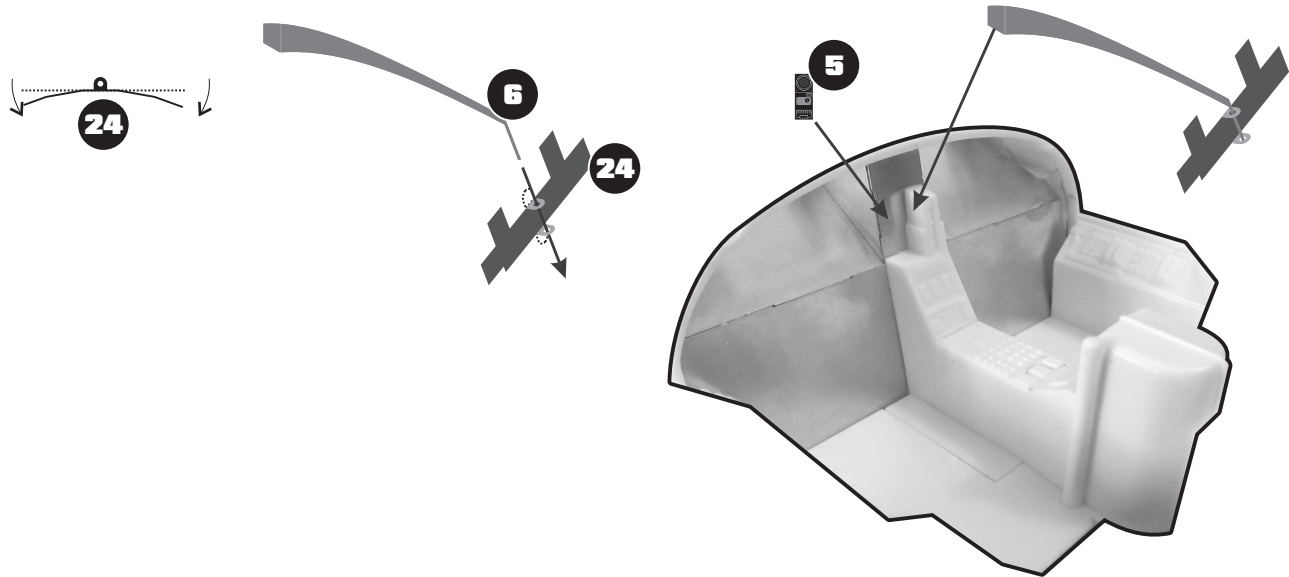

## “Gumballs” (Police Lights)

### Kit assembly steps 5 through 8

Fold etch parts 22 and 23 as shown.

Attach the lights to 22 and 23 per the diagram below. Note that some of the holes make be a bit tight and some adjustment of the lights' mounting pins may be necessary.

Once the lights are assembled, mount 22 to the car in place of kit assembly 6, and 23 in place of kit assembly 7.

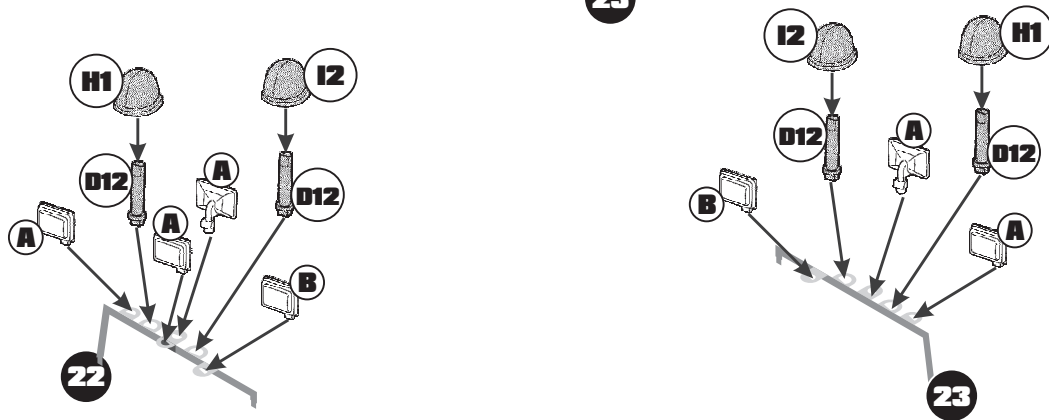
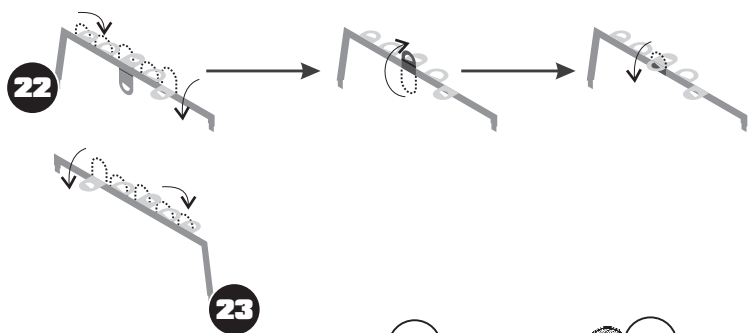

**PGMS**  
**ParaGrafix**  
 Modeling Systems

148 Rocklawn Ave.  
 Attleboro MA 02703 USA  
 +1 508-431-9800  
 www.ParaGrafix.biz

Special thanks to Gene Kozicki for his aid in researching this project.

Copyright © 2011 Paul H. Bodensiek. All rights reserved.  
 ParaGrafix™ and PGMS™ are TM Paul H. Bodensiek.