



Z-Shorty Series Starter Set Common Instruction Manual

Thank you for purchasing this Rokuhan product.

This product is precision train model. Please read this instruction manual carefully before operation.

⚠ Caution (Please Read Thoroughly)

- Please put rails on a flat place. And excessive force during attachment or detachment could cause damage joiner and rails.
- Please make sure rails are placed correctly before operation. Otherwise trains could get derailed or damaged.
- All illustration in this sheet shows E259 Narita Express as an example.

1 Let's check the contents!

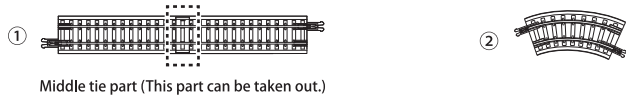

Middle tie part (This part can be taken out.)



* Figure ③ shows E259 Narita Express included in SG003-1.



Arnold Coupler (already set up)

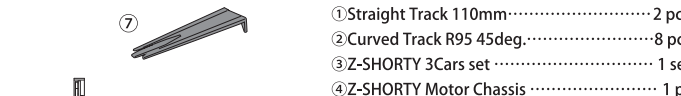

- ① Straight Track 110mm.....2 pcs
- ② Curved Track R95 45deg.....8 pcs
- ③ Z-SHORTY 3 Cars set.....1 set
- ④ Z-SHORTY Motor Chassis.....1 pc (Normal type or Shinkansen type)
- ⑤ Drawbar.....2 or 3 pcs
* The necessary pieces are changed according to cars.
- ⑥ Trailer Chassis.....2 pcs (Normal type or Shinkansen type)
- ⑦ Rerailer.....1 pc
- ⑧ RC-004 Train Controller.....1 pc
- ⑨ Instruction Manuals (This sheet/ RC-004).....1 sheet each

* RC-004 instruction manual is in the RC-004 package.

2 Let's connect the rails!

Assemble a track on a flat surface referring to the figure shown below.

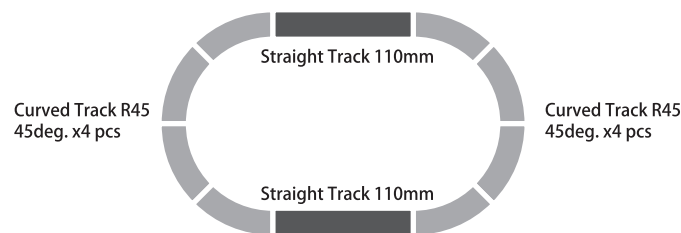

Connect horizontally, straight, and on a flat surface, and push in until it clicks.

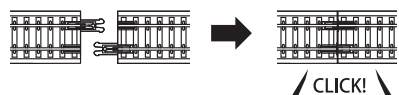

Please pull track to disconnect horizontally and straight without twisting.

CLICK!

3 Let's prepare controller!

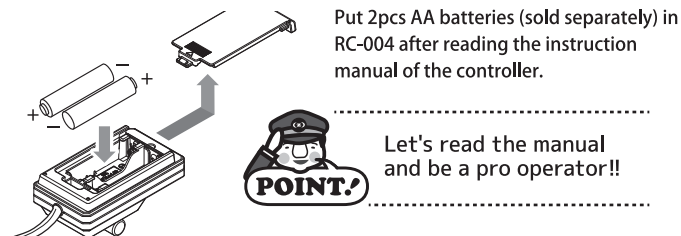

Put 2pcs AA batteries (sold separately) in RC-004 after reading the instruction manual of the controller.

Let's read the manual and be a pro operator!!

4 Let's connect the rails and the controller!

<Feeder cable>

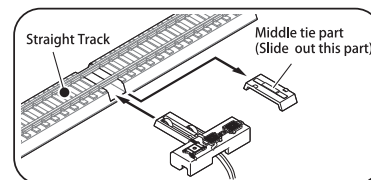

Feeder is in the center of the straight track (110mm straight). Please slide out the middle tie part from roadbed and push Feeder plug of RC-004 Train Controller into Feeder its root.

5 Let's motorize the cars!

1 Take out body shells and pilot parts from each dummy chassises.

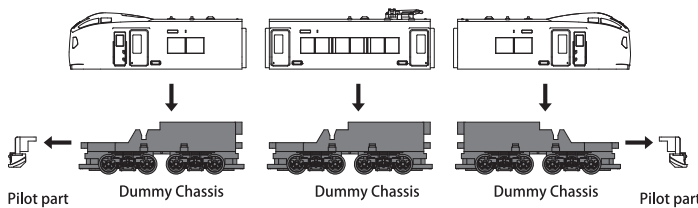

2 Put back body shells and pilot parts on motor chassis and trailer chassis in each place.

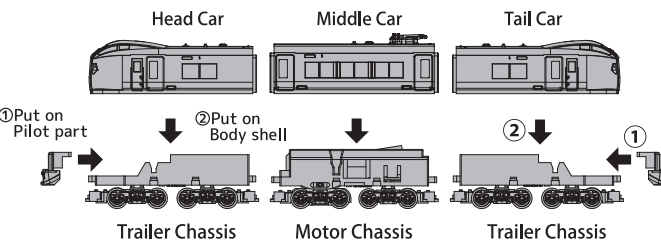

* Some cars do not have pilot parts (①). Take Arnold couplers off trailer chassis and motor chassis, and put drawbars in.

3 Take Arnold couplers off trailer chassis and motor chassis, and put drawbars in.

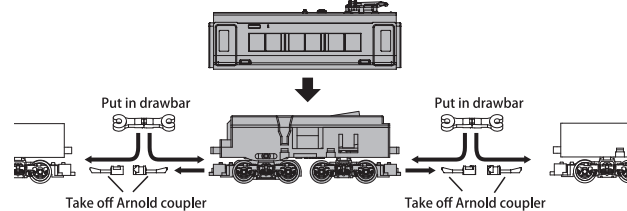

POINT! Drawbars provide more stable coupling in curved rails!

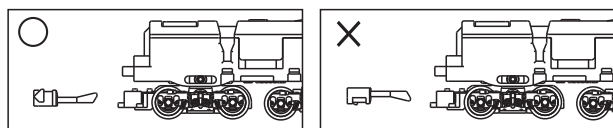

* Make sure Arnold couplers are installed in place.

6 Let's put cars on the rails!

1 Put rerailer on the straight track 110mm as shown on the Right figure.

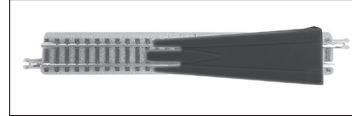

2 Put cars on the groove of rerailer and place them on the rail to slide it slowly with your fingertips.

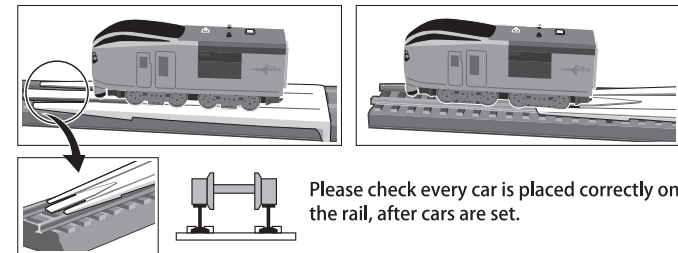

* Use the rerailer when you put cars on the rails. By sliding wheels to groove of the rerailer, it helps easier to put on the rails. Please put in order of Head cars, Middle cars and Tail cars.

7 Let's make run!

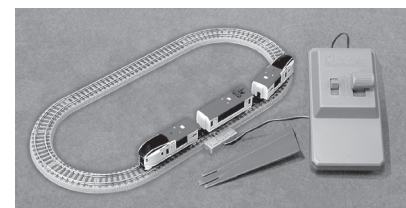

Get Z-SHORTY cars run with RC-004 train controller!



* If the train does not run smoothly, rails or wheels may be dirty. Please wipe out dirt by rail cleaner with soft cloth.

8 Let's play more with Z-Shorty Set!

After having fun with Z-SHORTY Starter Set, Let's enjoy other combination with other products sold separately.

Level 1 Dogbone Layout

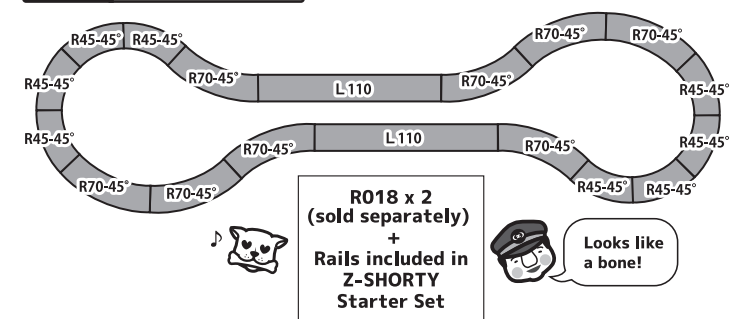

R018 x 2 (sold separately) + Rails included in Z-SHORTY Starter Set



Level 2 Switch-Yard Layout

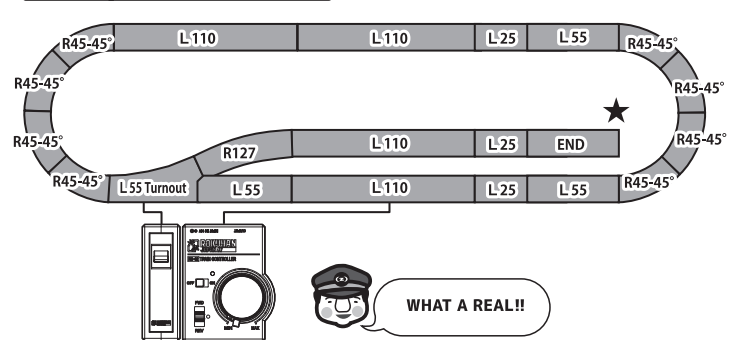

WHAT A REAL!!

C002 Turnout Switch (sold separately) R001 x 1 R022 x 1 R013 x 1 R024 x 1 R019 x 1 R030 x 1 (sold separately)

+ Rails included in Z-SHORTY Starter Set

Level 3 Flavoring a layout with scenery

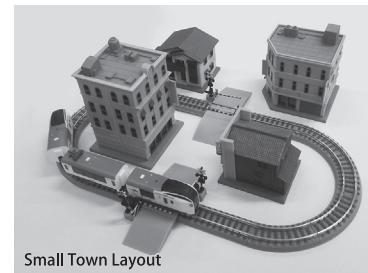

Just adding scenery items such buildings and railway-crossing give your layout more characteristic!

S033-1 Office Building A S041-2 Store C-2 Brown S034-1 Corner Shop Building A S042-2 House A-2 S045-1 Crossing JAPAN etc., Structures (sold separately)

+ Rails included in Z-SHORTY Starter Set

9 Let's reach a Higher Level!!

Use Drawbar instead Arnold coupler to form "Head to Head" connection (for ST001-1 os ST004-1)

1 Head to Head Formation

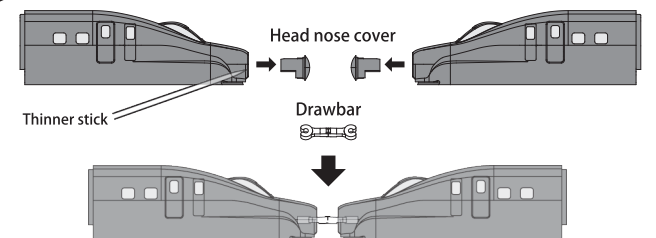

2 Long Formation Get more cars and chassis to build major train formation!!

Body shells and trailer chassis for the connected number of cars are necessary, if you want to run more coupled trains. (One motor chassis pulls maximum three trailer chassis.)



10 Troubleshooting

Check followings issues before ordering repair.

Problem	Cause	Correction
A train does not run smoothly.	Metal rails are dirty.	Remove the dirt with cleaner.
	Wheels are dirty.	Remove dirt with cleaner.
A train does not work	Trains are derailed, especially motor car.	Set a train proper on the rails.

11 Trouble and repair

- The user is responsible for any troubles, accidents or injury caused by misuse, disassembling or modification of this product. Rokuhan has no responsibility to repair any products which are disassembled and modified by users.
- Product specification and appearance are subject to change without prior notice.
- Available only completed products, not sold part by part.
- Please contact Rokuhan customer service, if you have any questions about this product.



7-27. NUMAWADA, TOCHIGI-CITY, 328-0042, JAPAN.
TEL : 81-282-20-2365
URL : <http://www.rokuhan.com/english/>
Opening hour: 10:00 - 12:00, 13:00-17:00 (except Saturday, Sunday, and holidays)